

**NOTES:**

1. Ultimate compression load 60 kips
2. Load to torque ratio (Kt) = 9
3. Torque strength rating = 6,000 ft-lb
4. Shaft: Round Structural ERW tubing per ASTM A500, Grade B, 2.875" O.D.
5. Uses three A307 Grade A 3/4" bolts to attached to an extension.
6. All extension are cold form in one end
7. Available nominal lengths are 5', 7' and 10.5'
8. Cold form ribs on helix help increase rigidity and strength.
9. Available helix sizes are 8", 10", 12" AND 14" in diameter.
10. Robotic welding is used to control quality.
11. A minimum factor of safety of 2.0 is recommended for determining allowable capacity from correlations with final installation torque.

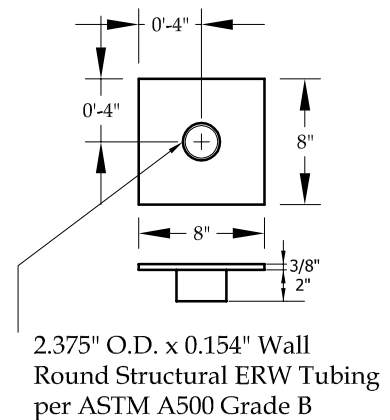
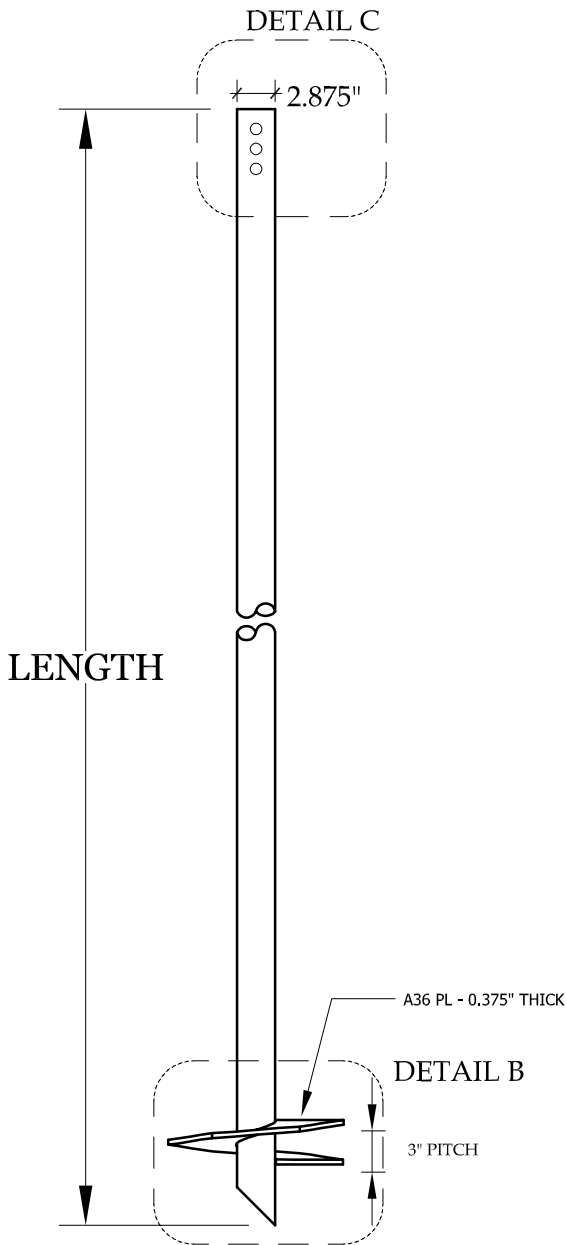

**D PILE CAP**  
1" = 1'-0"

**A HELICAL PILE LEAD**  
3/4" = 1'-0"

2 7/8" O.D. SCH40  
0.203" NOMINAL WALL THICKNESS

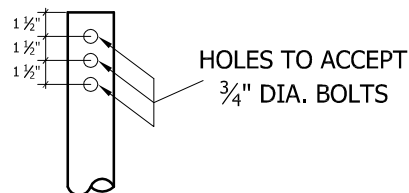

**C PILE LEAD DETAIL**  
1" = 1'-0"

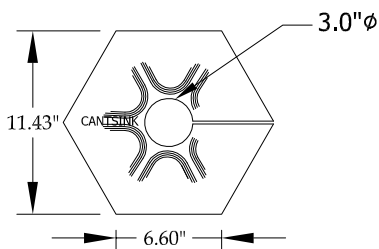

**B HELIX**  
1" = 1'-0"



		71 First Avenue, N.W. Lilburn, Georgia 30047 678-280-PILE(7453) FAX: 678-280-3476	
Title: CANTSINK HELICAL PILE LEAD		Catalog No. 2.5-40L07-12	
Project: ----		Revision: o8-2017	
Address: ----		Scale: N.T.S.	
Revision: o8-2017		Drawn by: LS	
Revision: o8-2017		Sheet: 1/2	